

REV	DATE	DESCRIPTION	ECO	SIGN
A	11/1/05	RELEASE TO PRODUCTION		

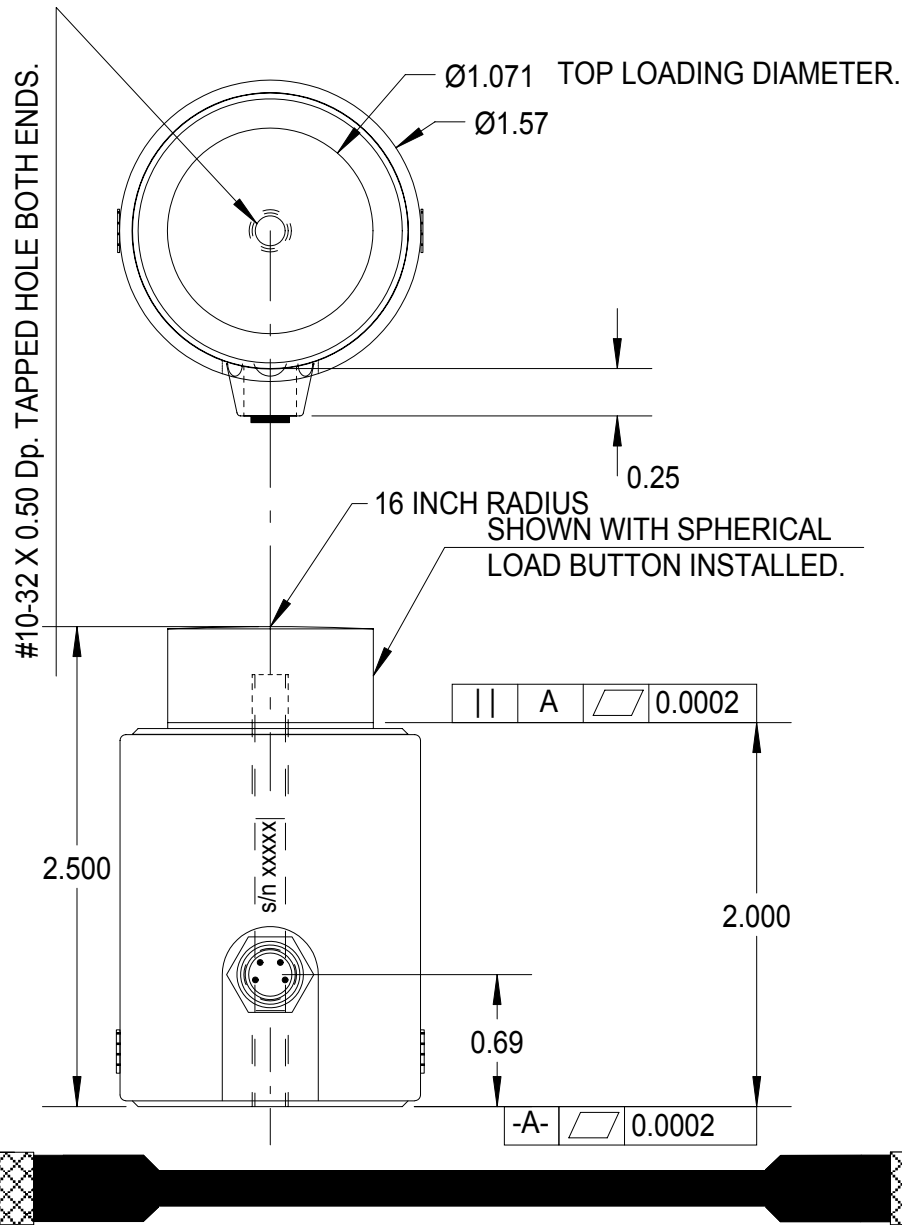

SPECIFICATIONS:

RATED CAPACITY	50,000 POUNDS
RATED OUTPUT	2 mV/V typical
COMBINED ERROR	0.15 % F.S.
NON-REPEATABILITY	0.01 % F.S.
ZERO BALANCE	± 10 % R.O.
TEMPERATURE RANGE, COMPENSATED	+60 TO 160° F
TEMPERATURE EFFECT, OUTPUT	0.001 % of Load / ° F
TEMPERATURE EFFECT, ZERO BALANCE	Not rated
INPUT IMPEDANCE, OUTPUT IMPEDANCE	1,000 OHMS, typical
EXCITATION VOLTAGE (typical)	10 VDC or VAC rms
EXCITATION VOLTAGE, MAXIMUM	15 VDC or VAC rms
INSULATION RESISTANCE	5,000 MEG OHMS @ 50 VDC
MAXIMUM LOAD, SAFE	150 % F.S.
MAXIMUM LOAD, ULTIMATE	200 % F.S.
DEFLECTION AT RATED CAPACITY, APPROXIMATE	0.003 in.
CONSTRUCTION	STAINLESS STEEL
CABLE	6 Ft.

WIRE COLOR CODE:	T.T.I. STD.	PIN NO.
+EXCITATION	BROWN GREEN	1
+SIGNAL	WHITE WHITE	2
- SIG	BLUE RED	3
- EXCITATION	BLACK BLACK	4

MALE PLUG OR MALE RECEPTACLE

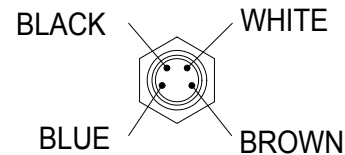

Part Number with button:	TT49S50K
Part Number without button: (STANDARD)	TT49F50K
File Name	16063SP.FCD
Doc. No.	16063

TOLERANCES UNLESS OTHERWISE SPECIFIED:

.XXX = ± 0.005

.XX = ± 0.015

.X = ± 0.025

SCALE: FULL

FINISH: FINE BRUSHED

MAT'L: STAINLESS STEEL

HARDNESS:



TOLEDO  
TRANSDUCERS,  
INC.

Designed By: **Mettert**

Drawn By:

Approved By:

Date: **4/21/97**

Date:

Date:

Title / Description:  
**TT49F, 50,000 POUND  
FLAT TOP LOAD CELL**

Dwg. Size:  
**A**

Dwg. Type:  
**SPEC**

Page 1 of 1