

REV	DATE	DESCRIPTION	ECO	SIGN
1	11/13/14	RELEASE TO PILOT		BKM
2	6/23/15	RELEASE	1358	BCO

SPECIFICATIONS:

RATED CAPACITY, TENSION AND OR COMPRESSION	20,000 POUNDS
RATED OUTPUT	2 mV/V
COMBINED ERROR	±0.25% OF F.S.
NON-REPEATABILITY	0.05%
ZERO BALANCE	±1%
TEMPERATURE RANGE, COMPENSATED	50° to 150°F
TEMPERATURE EFFECT, OUTPUT	0.018%/°F
TEMPERATURE EFFECT, ZERO BALANCE	0.005%/°F
INPUT IMPEDANCE, (typical)	350 OHMS
EXCITATION VOLTAGE (typical)	10VDC or VAC rms
EXCITATION VOLTAGE, MAXIMUM	15VDC or VAC rms
INSULATION RESISTANCE	5,000 MEG.OHMS @ 50 VDC
MAXIMUM LOAD, SAFE	150% F.S.
MAXIMUM LOAD, ULTIMATE	200% F.S.
NORMAL INSTALLATION TORQUE: 500 FT-LBS	
1,000 FT-LBS OR MORE WILL RESULT IN UNREPAIRABLE DAMAGE	



TURCK FEMALE CORDSET RK 4.5T-4/S618, ORDER NO. (4245-222)

TURCK  
MALE RECEPTACLE WIRING DIAGRAM  
(RECEPTACLE FRONT SIDE)

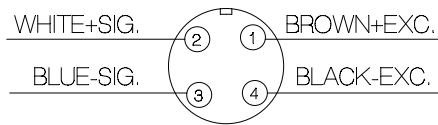

WIRE COLOR CODE:	PIN NO.
+EXCITATION	BROWN 1
+SIGNAL	WHITE 2
-SIGNAL	BLUE 3
-EXCITATION	BLACK 4

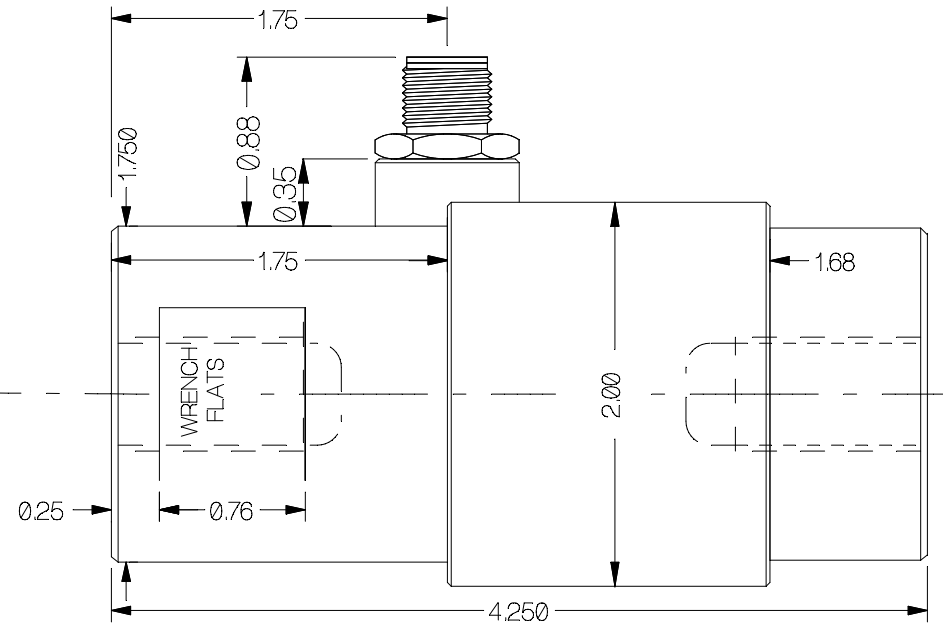
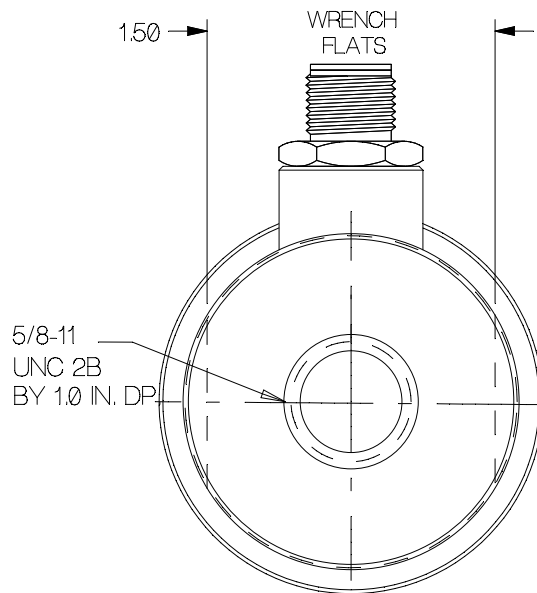

5/8-11  
UNC 2B  
BY 1.0 IN. DP

TOLERANCES UNLESS OTHERWISE SPECIFIED:

XXX=0.005	SCALE: FULL
XX=0.015	
X=0.025	

FINISH: BRUSHED STAINLESS COVER  
LOAD CELL MAT'L: ALLOY STEEL



TOLEDO  
TRANSDUCERS,  
INC.

Designed By:	Mettert	Date:	11/13/14
Drawn By:		Date:	
Approved By:		Date:	

Title / Description:		Part No.
SS1703FF20K POUND UNIVERSAL LOAD CELL		
Dwg Size:	Dwg. Type:	File Name
A	SPEC	17543
Page 1 of 1		Doc. No.
		17543