

REV	DATE	DESCRIPTION	ECO	SIGN
1	6/17/09	RELEASE TO PILOT		BKM

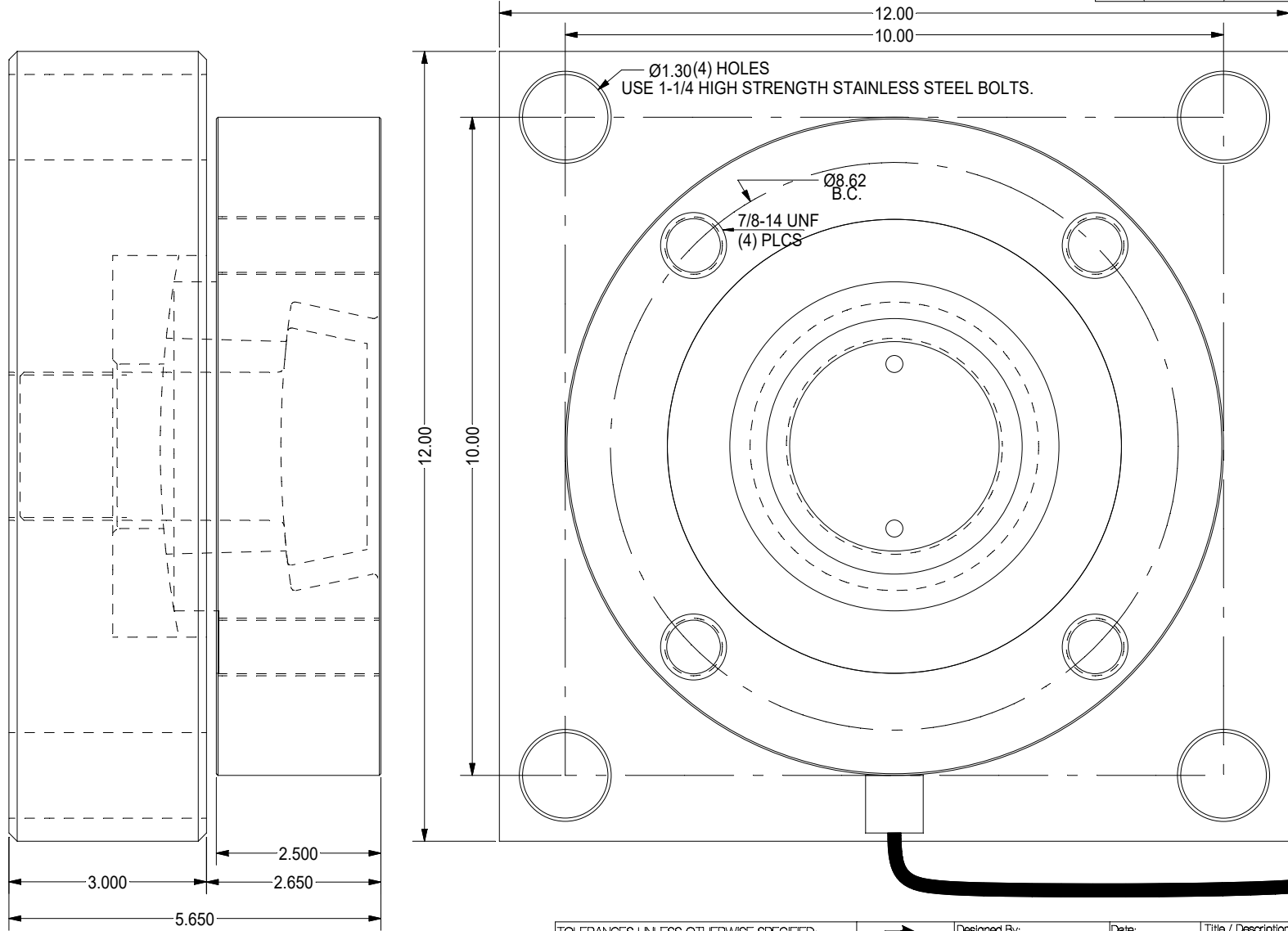

SPECIFICATIONS:

Rated Capacity, (COMPRESSION)	300KLB - 450KLB
Rated Output, typical	3 mV/V
Combined error	0.15 % F.S.
Non-repeatability	0.02 % F.S.
Zero Balance	1 % R.O.
Temperature Range, Compensated	0° F to 150° F
Temperature Effect, Output	0.0008 % of load / ° F
Temperature Effects, Zero Balance	0.0025 % / R.O. / ° F
Bridge Impedance, Typical	700 ohms
Excitation Voltage, Typical	10 VDC or VAC rms
Excitation Voltage, Maximum	15 VDC or VAC rms
Insulation Resistance	> 5,000 megohms at 50 VDC
Overload, Safe	150 % over capacity
Pullout, Safe	100 % Rated Capacity
Side Load, Safe	100 % Rated Capacity
Angular Misalignment	+/- 1.5 Deg.

Deflection at Rated Capacity, Approximate 0.005 inch
 Construction, Washdown All Stainless Steel

Cable color code:

GREEN	+ Excitation
Black	- Excitation
WHITE	+ Signal
RED	- Signal
Shield	Floats at cell
Cable Length	25 feet
Conduit Adapter	1/2-14 NPT

NOTE:
 TOP PLATE REQUIRED IF LEG MATERIAL IS LESS THAN 3 INCH THICK.
 BASE & TOP PLATE STAINLESS STEEL



TOLERANCES UNLESS OTHERWISE SPECIFIED:
 XXX = ± 0.005
 XX = ± 0.015
 X = ± 0.025
 FINISH:
 MAT'L: ALL ATAINLESS STEEL
 HARDNESS:



Designed By: Mettert	Date: 6/18-09	Title / Description: SS1577-300KLB - 450KLB TANK LEG KIT LOAD CELL	Part No. SS1577-300KLB - 450KLB
Drawn By:	Date:		File Name
Approved By:	Date:	Dwg Size: B Dwg Type: SPEC	Doc. No.