

REV	DATE	DESCRIPTION	ECO	SIGN
1	4/1/09	RELEASE TO PILOT / QUOTE		BKM

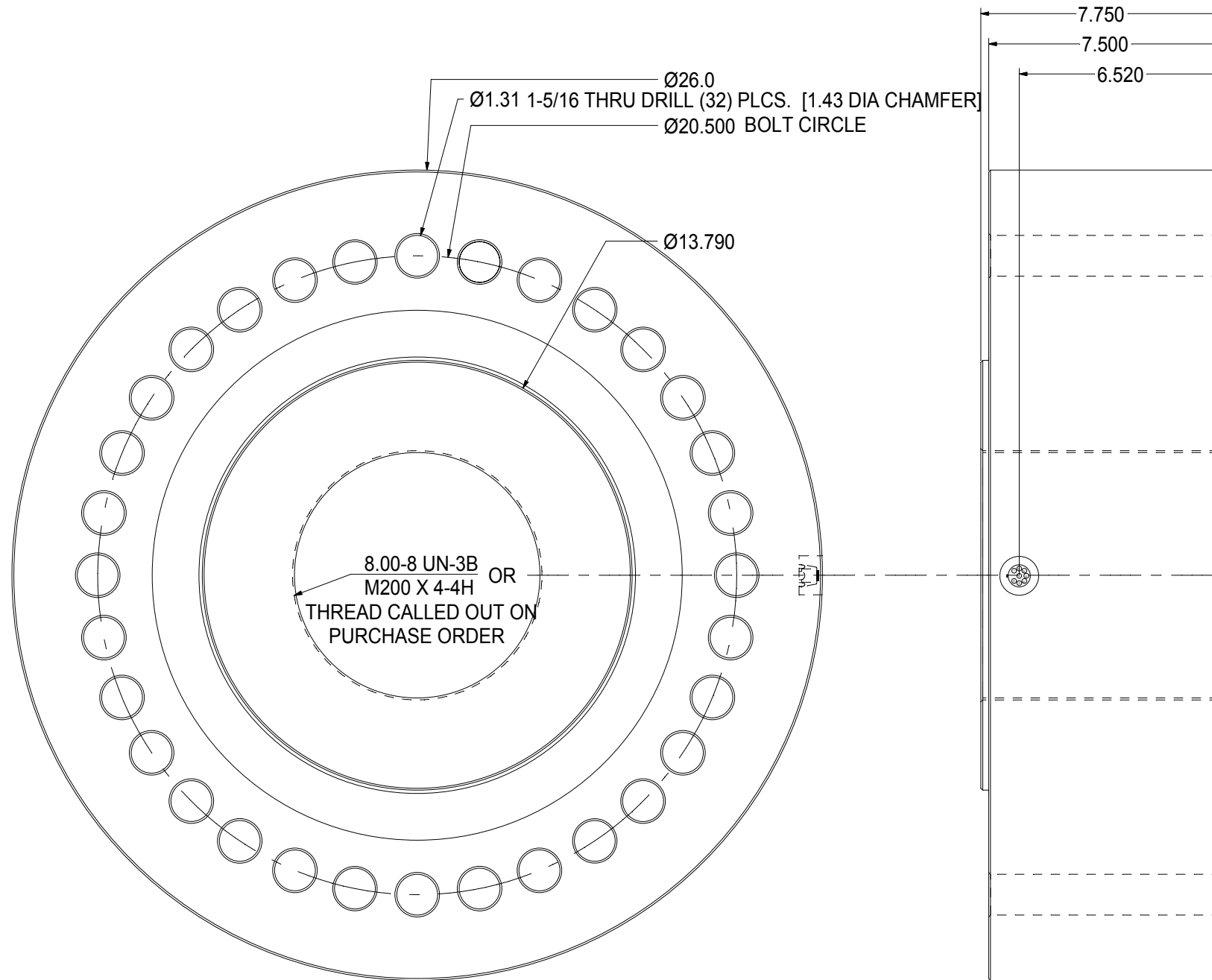

SPECIFICATIONS:

Rated Capacity	1,000,000 pounds
Rated Output, Typical	2 mV/V
Combined error, Typical	0.05 % F.S.
Non-repeatability	0.02 % F.S.
Zero Balance	2 % R.O.
Temperature Range, Compensated	32° F to 150° F
Temperature Effect, Output	0.0015 % of load / ° F
Temperature Effects, Zero Balance	NOT RATED
Temperature Range, Useable	-14° F to 200° F
Bridge Impedance, Typical	350 OHMS EACH BRIDGE
Excitation Voltage, Typical	10 VDC or VAC rms
Insulation Resistance	> 5,000 megohms at 50 VDC
Overload, Safe	200 % over Rated Capacity
Overload, Ultimate	300 % over Rated Capacity
Construction	Painted Alloy Steel

TURCK FS 8-05/14.5

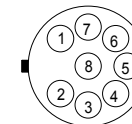

PIN NO.	TURCK COLOR CODE:	INTERNAL BRIDGE COLOR
1	+EXCITATION 1 WHITE	GREEN
2	- EXCITATION 1 BROWN	BLACK
3	+ SIG BRIDGE 1 GREEN	WHITE
4	- SIG BRIDGE 1 YELLOW	RED
5	+EXCITATION 2 GRAY	WHITE
6	- EXCITATION 2 PINK	RED
7	+ SIG BRIDGE 2 BLUE	WHITE
8	- SIG BRIDGE 2 RED	RED

TOLERANCES UNLESS OTHERWISE SPECIFIED:
 XXX = ± 0.005
 XX = ± 0.015
 X = ± 0.025

SCALE: FULL



TOLEDO
TRANSDUCERS,
INC.

Designed By: Mettert

Date: 4/1/09

Drawn By:

Date:

Approved By:

Date:

Title / Description:
 SS1568F1MLB OR SS1568F1MLB-D
 UNIVERSAL LOAD CELL
 SPECIFICATIONS

Dwg. Size: D
 Dwg. Type: SPECS

Part No. SS1568F1MLB

File Name 16636

Doc. No. 16636