

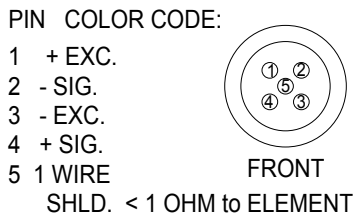

REV	DATE	DESCRIPTION	ECO	SIGN

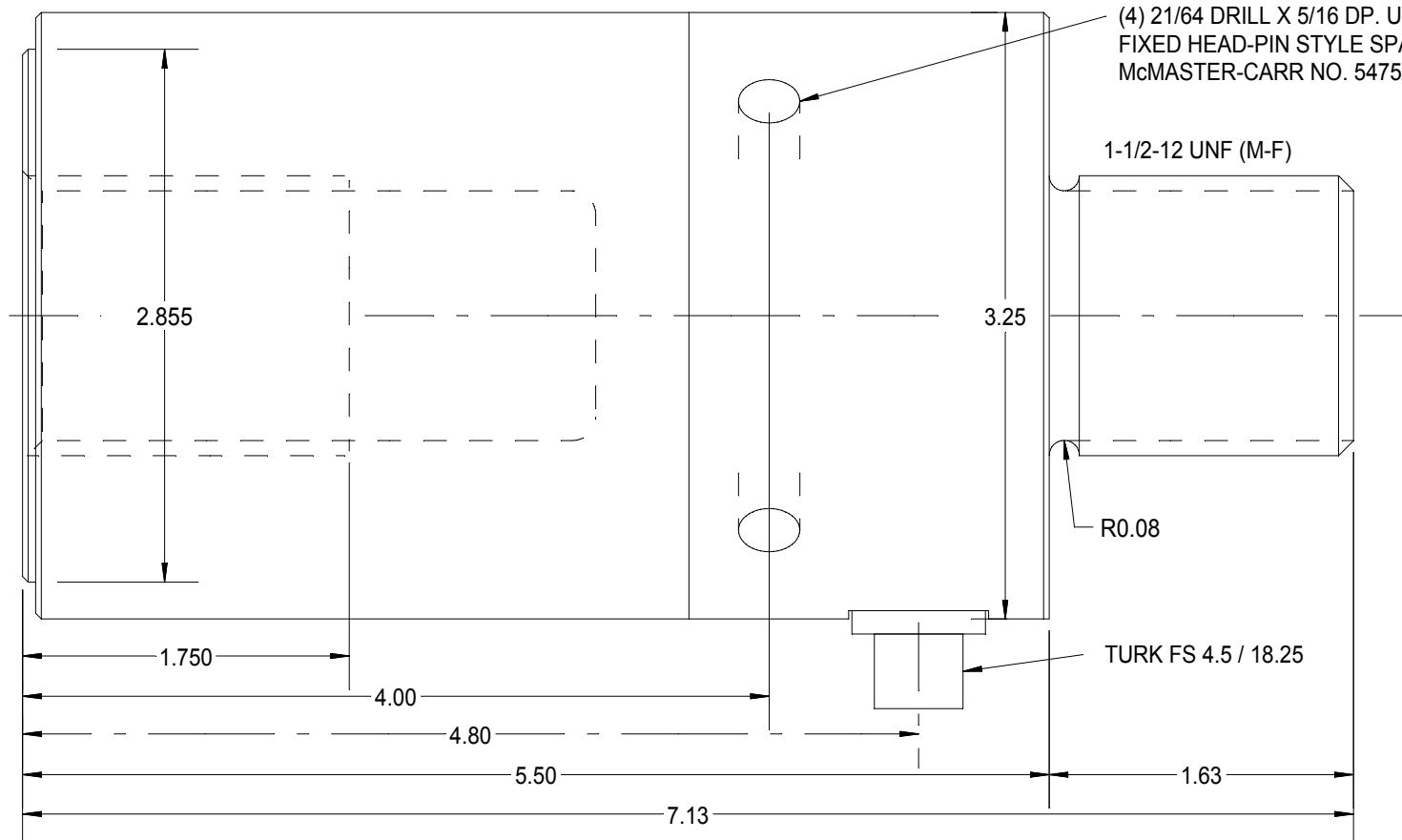

SPECIFICATIONS:

RATED CAPACITY	500,000 N
RATED OUTPUT, matched	2.00 ± 0.01 mV/V
COMBINED ERROR	± 0.25 %
NON-REPEATABILITY	< 0.05 %
ZERO BALANCE	± 1 %
TEMPERATURE RANGE, COMPENSATED	+60 TO 160° F
TEMPERATURE EFFECT, OUTPUT	0.0005 % of Load / ° F
TEMPERATURE EFFECT, ZERO BALANCE	Not rated

SPECIFICATIONS:

INPUT IMPEDANCE	350 typical
OUTPUT IMPEDANCE	350 OHMS, typical
EXCITATION VOLTAGE (typical)	10 VDC or VAC rms
EXCITATION VOLTAGE, MAXIMUM	15 VDC or VAC rms
INSULATION RESISTANCE	5,000 MEG OHMS @ 50 VDC
MAXIMUM LOAD, SAFE	150 % F.S.
MAXIMUM LOAD, ULTIMATE	300 % F.S.
DEFLECTION AT RATED CAPACITY, APPROXIMATE	0.002 in.

TOLERANCES UNLESS OTHERWISE SPECIFIED:

.XXX = ± 0.005	SCALE: FULL
.XX = ± 0.015	
.X = ± 0.025	

FINISH: 32 MICRO INCH OR LESS
 STAINLESS STEEL COVER,
 TOOL STEEL ELEMENT



Designed By: **Mettert**

Date: **1/2/02**

Drawn By:

Date:

Approved By:

Date:

Title / Description:
**SS1401-500kN INSERTION
 LOAD CELL**

Dwg. Size:
A

Dwg. Type:
SPEC

Part No. **SS1401**

File Name **12489SP.FCD**

Doc. No. **12489**