

REV	DATE	DESCRIPTION	ECO	SIGN
1	7/20/00	RELEASE TO PILOT	942	RAB
A	7/26/00	RELEASE TO PROD. CHANGE CABLE TO 3FT	945	RAB

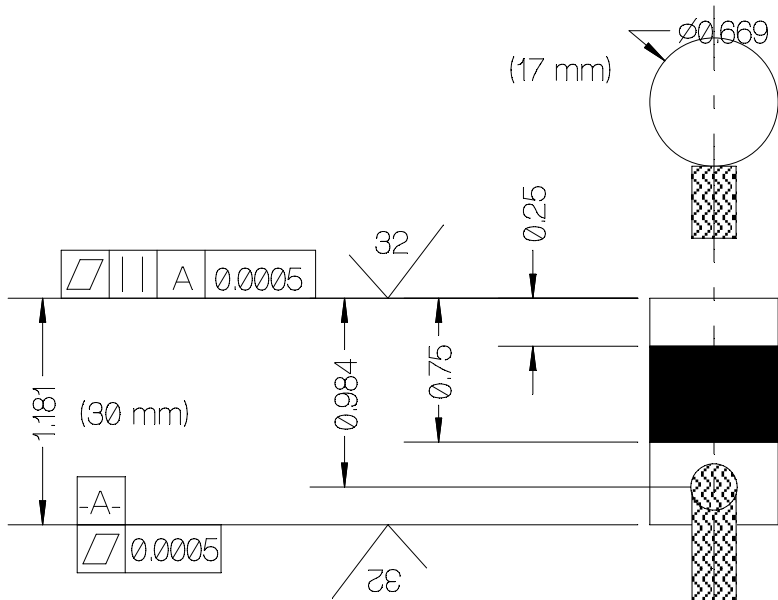

SPECIFICATIONS:

RATED CAPACITY	
RATED OUTPUT, matched	2.00 ± 0.01 mV/V
COMBINED ERROR	± 0.25 %
NON-REPEATABILITY	< 0.05 %
ZERO BALANCE	± 10 %
TEMPERATURE RANGE, COMPENSATED	+60 TO 160° F
TEMPERATURE EFFECT, OUTPUT	0.015 % of Load / ° F
TEMPERATURE EFFECT, ZERO BALANCE	Not rated
INPUT IMPEDANCE	350 to 390 OHMS, typical
OUTPUT IMPEDANCE	350 OHMS, typical
EXCITATION VOLTAGE (typical)	10 VDC or VAC rms
EXCITATION VOLTAGE, MAXIMUM	15 VDC or VAC rms
INSULATION RESISTANCE	5,000 MEG OHMS @ 50 VDC
MAXIMUM LOAD, SAFE	150 % F.S.
MAXIMUM LOAD, ULTIMATE	300 % F.S.
DEFLECTION AT RATED CAPACITY, APPROXIMATE CONSTRUCTION	

3 FEET OF STAINLESS STEEL FLEX METAL HOSE.

LUMBERG MALE 4 PIN 4/7

PIN COLOR CODE:

- 1 GREEN + EXC.
- 2 BLACK - EXC.
- 3 WHITE + SIG.
- 4 RED - SIG.

SHLD. < 1 OHM to ELEMENT
FLOATS AT CONNECTOR

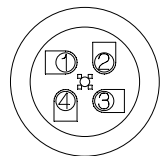

INSIDE PLUG

TOLERANCES UNLESS OTHERWISE SPECIFIED:

XXX = ± 0.005
XX = ± 0.015
X = ± 0.025

SCALE: FULL

FINISH: AS NOTED

MAT'L: ALLOY TOOL STEEL

HARDNESS: Rc 40-46



TOLEDO
TRANSDUCERS,
INC.

Designed By: METTERT

Date: 7/20/2000

Drawn By:

Date:

Approved By:

Date:

Title / Description:
SS1335 10,000 POUND
COMPRESSION LOAD CELL
MACHINED ELEMENT

Dwg Size: A
Dwg. Type: SPEC

Page 1 of 1

Part No. SS1335-10K

File Name 12216SP.FCD

Doc. No. 12216