

REV	DATE	DESCRIPTION	ECO	SIGN

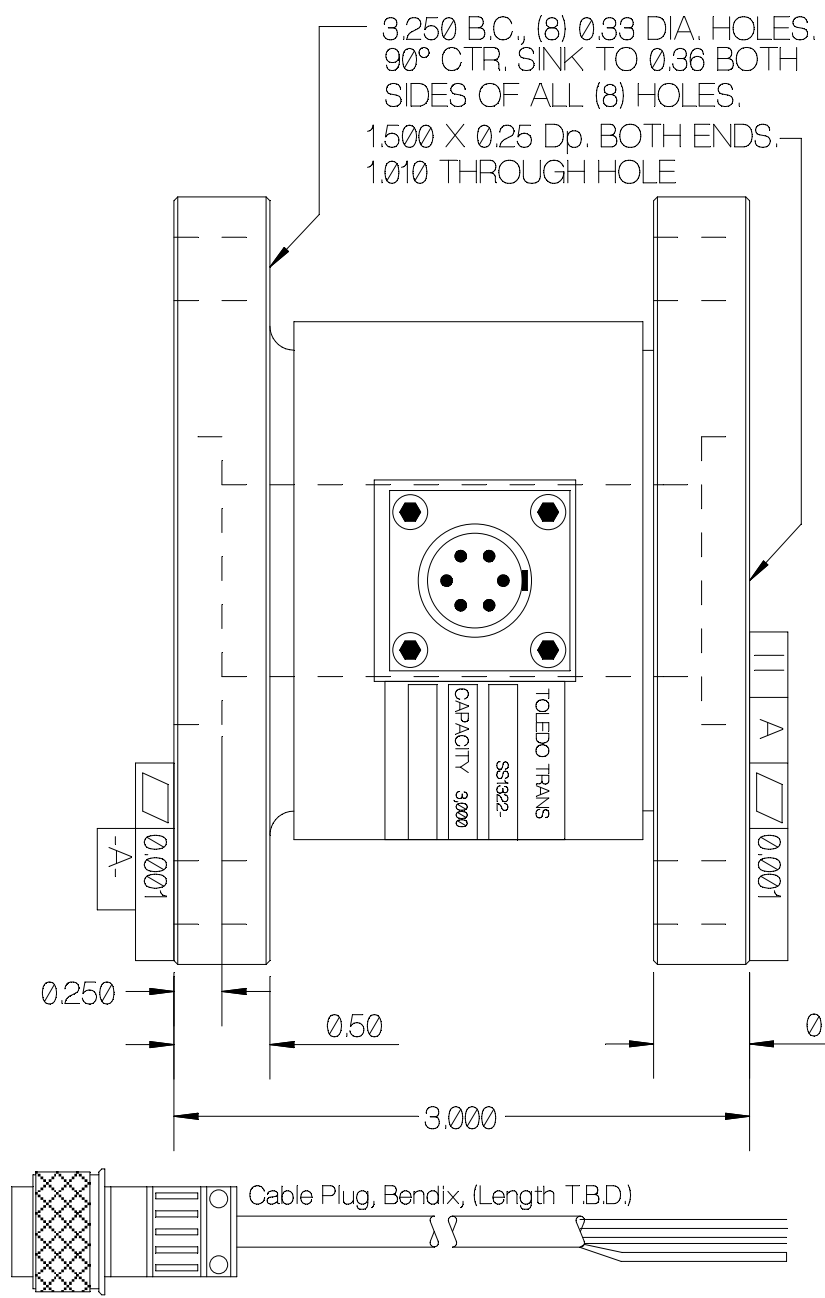

SPECIFICATIONS:

Rated Capacity	3,000 inch-pounds
Rated Output, typical	2 mV/V
Combined error	0.1 % F.S.
Non-repeatability	0.05 % F.S.
Zero Balance	1 % R.O.
Temperature Range, Compensated	50 F to 120 F
Temperature Effect, Output	0.005 % of load / F
Temperature Effects, Zero Balance	0.005 % / R.O. / F
Bridge Impedance, Typical	350 ohms
Excitation Voltage, Typical	10 VDC or VAC rms
Excitation Voltage, Maximum	15 VDC or VAC rms
Insulation Resistance	> 5,000 megohms at 50 VDC
Overload, Safe	150 % over capacity
Overload, Ultimate	200 % over capacity
Construction	Aluminum

PIN	COLOR	
A	RED	+ EXC.
B		
C	BLACK	- EXC.
D		
E	GREEN	- SIG.
F	WHITE	+SIG.

SHLD. FLOATS > 5KM OHMS TO GROUND

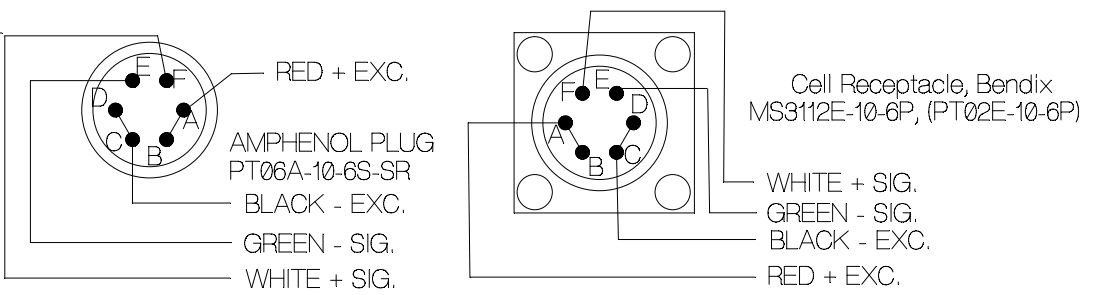

TOLERANCES UNLESS OTHERWISE SPECIFIED:
 XXX = ± 0.005
 .XX = ± 0.015
 .X = ± 0.025

SCALE: FULL

FINISH: FINE BRUSHED LOOK ON TOOL MARKS
 MAT'L: ANY ALUMINUM



Designed By: Mettert
 Drawn By:
 Approved By:

Date: 2/7/00
 Date:
 Date:

Title / Description:
 SS1322-3,000 IN-LB RADIAL
 FORCE TRANSDUCER
 SPECIFICATIONS

Dwg Size: A
 Dwg. Type: SPEC

Page 1 of 1

Part No. SS1322-3,000 IN-LB
 File Name 11560SP.FCD
 Doc. No. 11560