

REV	DATE	DESCRIPTION	ECO	SIGN
1	11/4/2008	RELEASE TO PILOT		

20 FOOT LONG CABLE

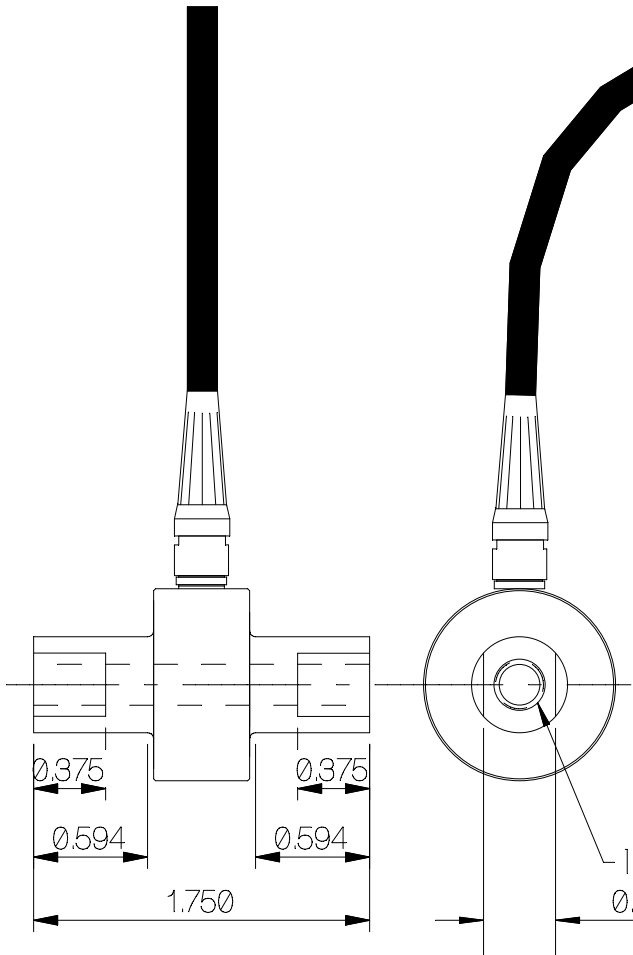

SPECIFICATIONS:

Rated Capacity	3kN
Rated Output, typical	2 mV/V
Combined error	0.25 % F.S.
Non-repeatability	0.05 % F.S.
Zero Balance	1 % R.O.
Temperature Range, Compensated	50 F to 120 F
Temperature Effect, Output	0.005 % of load / F
Temperature Effects, Zero Balance	0.005 % / R.O. / F
Bridge Impedance, Typical	350 ohms
Excitation Voltage, Typical	10 VDC or VAC rms
Excitation Voltage, Maximum	15 VDC or VAC rms
Insulation Resistance	> 5,000 megohms at 50 VDC
Deflection at rated Capacity	0.0003 inch
Overload, Safe	300 % over capacity
Overload, Ultimate	400 % over capacity
Construction	Tool Steel

1/4-28 TAP X 0.50 DEEP

WIRE COLOR CODE:

+ EXCITATION	RED
- EXCITATION	BLACK
+ SIGNAL	WHITE
- SIGNAL	GREEN
SHIELD	FLOATS AT CELL



Designed By: Mettert	Date: 1/26/00	Title / Description: SS1321-3kN COMPRESSION TENSION UNIVERSAL LOAD CELL SPECIFICATIONS	Part No. SS1321-3kN
Drawn By:	Date:		File Name 16560
Approved By:	Date:	Dwg Size: A Dwg. Type: SPEC	Doc. No. 16560